

CL-201(S)-1702#-3

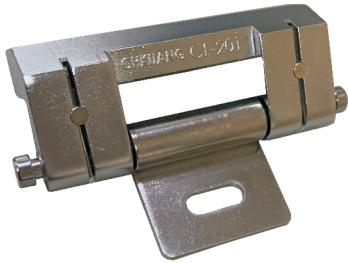

CL-201(B)-1702#-3

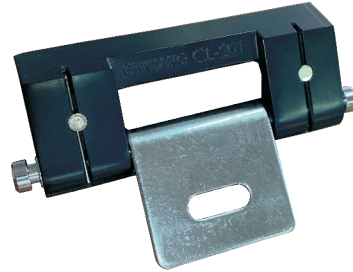

CL-201

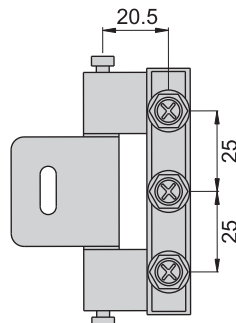
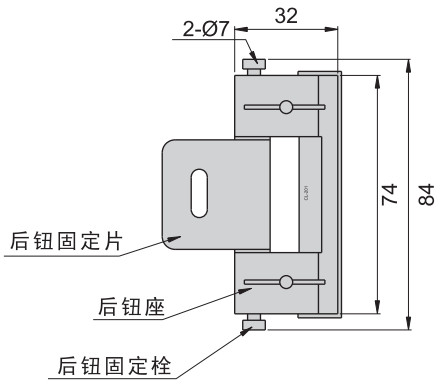

安装示意图

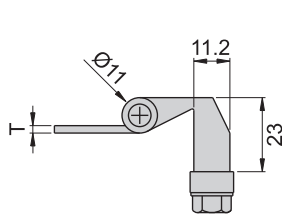

1702# T=2m/m
702# T=2.3m/m

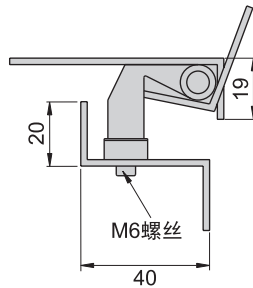

可搭配固定片

1702#-1
702#-1

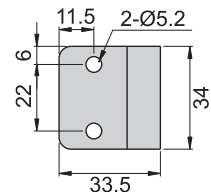

1702#-2
702#-2

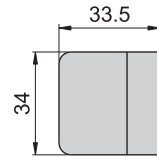

1702#-3
702#-3

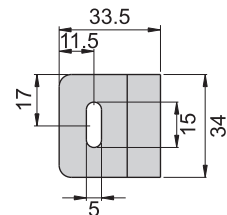

702#-1(B)

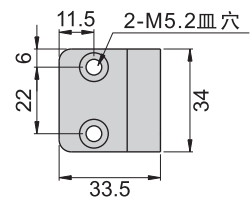

材 质	后钮座---锌合金(ZDC)
	固定片---1702#不锈钢(SUS 304) ---702#铁
表面处理	后钮座---(S)喷砂、镀铬(B)电著涂装黑色 固定片---702#材料本质

铰链