

1082#-R



1082#-L



1082#-1

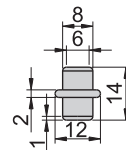

82#-2

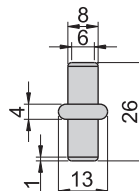

1082#-R
82#-R

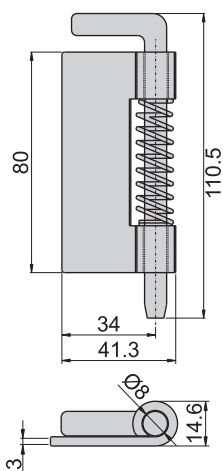

1082#-L
82#-L

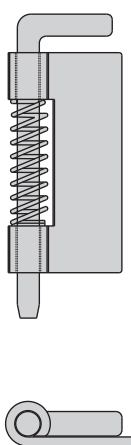

材 质	1082#、1082#-1、1082#-2---不锈钢(SUS 304)
	82#、82#-1、82#-2---铁
表面处理	82# 叶子---材料本质
	心轴---电钼
	82#-1、82#-2---电钼

铰
链

炸弹后钮



材 质	铁
表面处理	材料本质

B-322-100

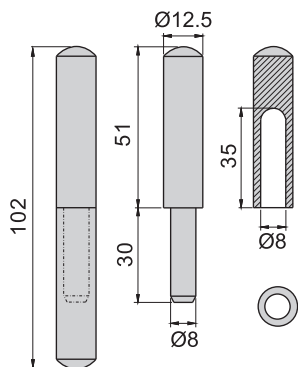

B-322-80

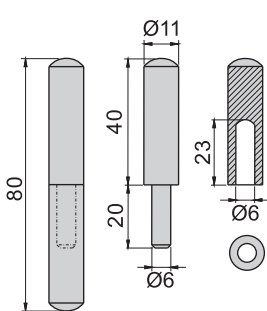

B-322-60

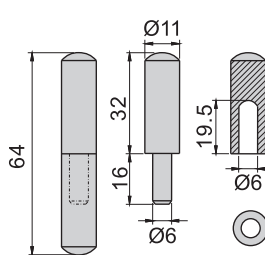

B-322-50

