

702#-1-C



702#-2-C



702#-3-C



702#-1-C(B)



1702#-1-B
702#-1-B

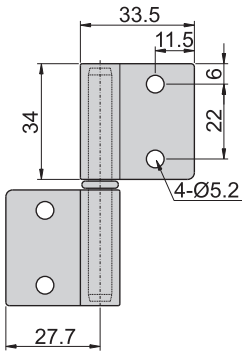

1702#-2-B
702#-2-B

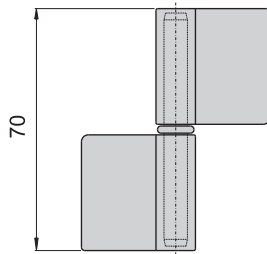

材 质	1702#---不锈钢(SUS 304)
	702#---铁
表面处理	702# 叶子---材料本质
	702#-1(B) ---砂面黑色耐刮面 心轴---电钲

1702#-3-C
702#-3-C

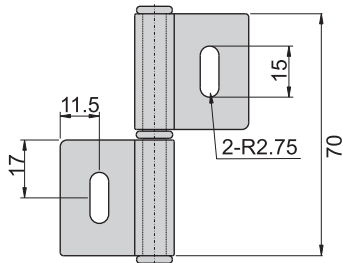

702#-1-D(B)

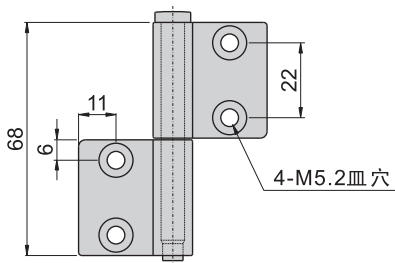

1702# T=2m/m
702# T=2.3m/m

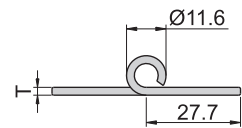

1702#、702# 用心轴

单边固定

双边活动

1702#-B
702#-B

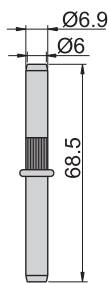

1702#-C
702#-C

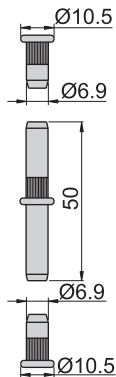

1702#-D
702#-D

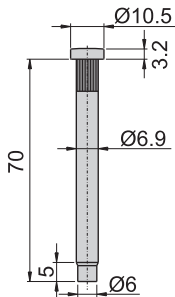

1702#-B1
702#-B1

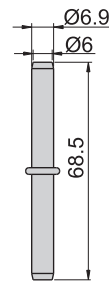

1702#-C1
702#-C1

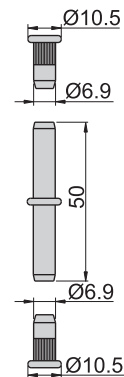

1702#-D1
702#-D1

